

# 手动隔膜阀 KST220

## MANUAL DIAPHRAGM VALVE

工作压力：0-10bar  
 工作温度：-40~150℃  
 驱动机构：手动控制  
 密封材质：EPDM,EPDM+TFM  
 阀体设计：直通阀体设计  
 阀体材质：316L（铸造，EN1.4409 CF3M）  
 接口尺寸：DN20/DN80  
 接口方式：KST220-1：焊式、KST220-2焊卡式、  
 KST220-3:卡式  
 表面处理：外表面Ra≤0.5μm（SF1），  
 内表面Ra≤0.375μm（SF4）  
 接口标准：ISO,DIN,ASME BPE.3A,BS

Working pressure: 0-10bar  
 Working temperature: -40~150℃  
 Drive mechanism: manual control  
 Seal material: EPDM+TFM, EPDM  
 Body design: straight through valve design  
 Body material: 316L (casting, CF3M EN1.4409)  
 Interface size: DN20/DN80  
 Interface type: KST220-1 type, KST220-2 type welding: welding,  
 KST220-3: card  
 Surface treatment: the outer surface of Ra is less than or equal to  
 0.5 m (SF1),  
 The inner surface of Ra is less than or equal to 0.375 m (SF4)  
 Interface standard: ISO, DIN, BPE.3A BS, ASME

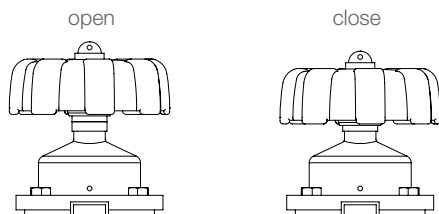

SIZE	DN20	DN25	DN40	DN50
open	11	14	22	28
close	1	1	1	1

### 驱动器

类型：KST-PC220

尺寸：DN20-DN80

主要材质：不锈钢阀帽、支座、阀杆、PC手轮

状态显示：手动开关状态显示如图

Drive

Type: KST-PC220

Size: DN20-DN80

Main material: stainless steel valve cap, bearing, valve stem, PC hand wheel

Status display: manual switch status display

# 手动隔膜阀 MANUAL DIAPHRAGM VALVE

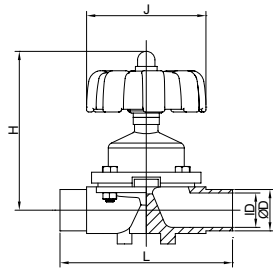

No.KST220-1

Size	ΦD	ΦD1	ID	L	H	J
DN15	19.1	-	15.8	108	95	65
DN20	22	-	18.1	108	105	90
DN25	28	-	22.1	120	110	90
DN32	35	-	28.5	153	140	110
DN40	40	-	34.8	153	140	110
DN50	52	-	47.5	173	170	130
DN65	67	-	60.3	216	200	180
DN80	88	-	81	254	220	180

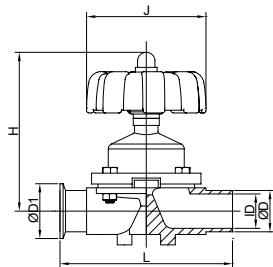

No.KST220-2

Size	ΦD	ΦD1	ID	L	H	J
DN15	19.1	50.5	15.8	108	95	65
DN20	22	50.5	18.1	112.5	105	90
DN25	28	50.5	22.1	123.5	110	90
DN32	35	50.5	28.5	156	140	110
DN40	40	50.5	34.8	156	140	110
DN50	52	64	47.5	181.5	170	130
DN65	67	77.5	60.3	216	200	180
DN80	88	106	81	254	220	180

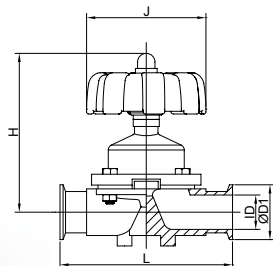

No.KST220-3

Size	ΦD	ΦD1	ID	L	H	J
DN15	-	50.5	15.8	108	95	65
DN20	-	50.5	18.1	117	105	90
DN25	-	50.5	22.1	127	110	90
DN32	-	50.5	28.5	159	140	110
DN40	-	50.5	34.8	159	140	110
DN50	-	64	47.5	190	170	130
DN65	-	77.5	60.3	216	200	180
DN80	-	106	81	254	220	180